

# CORRECT WIRING OF CHEMICAL FEED PUMP

using a water supply flow sensor with pump control



TREATED WATER OUT

240 VAC OPTIONS ALSO AVAILABLE



CONTACT  
TANK

CHEMICAL  
FEED PUMP

DO NOT WIRE CHEMICAL FEED PUMP  
TO PRESSURE SWITCH

Simple Plug & Go  
Installation

SOLUTION  
TANK

PRESSURE  
SWITCH

SOLUTION  
INJECTION TAP

WATER  
FLOW SENSOR

WELL PUMP

## WOMAN INJURED

SHE STEPPED INTO THE SHOWER. THE WATER CONTAINED TOO RICH A BLEND OF CAUSTIC SODA SOLUTION INSTALLED IN THE SYSTEM AS A MEANS OF ACID WATER NEUTRALIZATION. SHE WAS BURNED OVER HER ENTIRE BODY. THIS AND OTHER SERIOUS ACCIDENTS CAN BE AVOIDED BY USING THOMAS PRODUCTS LTD. FLOW SENSOR/PUMP CONTROLS.

## Self-Contained Pump Controls

No electrician needed, simply install the flow sensor into the water supply line and plug the pump control into the power outlet. UL approved, and specifically designed and patented for the water treatment industry.

When sufficient water is flowing, the flow sensor then energizes the pump control to turn on the chemical feed pump. Conversely, when there is insufficient water the chemical feed pump will not be turned on regardless of the line pressure.



SALES 800.666.9101

WWW.THOMASPROD.COM



# 1801 p/n 45325-B

Indoor Pump Control

Patent No. 5,162,624

(NOTE: 1801 is the most used residential model)



## 1801 Features\*

- 1" Slip Ports / Adapters Available On Page Six.
- Calibrated @ 0.5 GPM On Decreasing Flow.
- Flow Set Points Available To 6.0 GPM.
- Locking Wire For Easy Disassembly and Cleaning.
- True-Flow Switch Design Utilizes an SST Return Spring For Any Mounting Attitude.
- Input 120 VAC / Output 120 VAC 10A 1/2 HP.
- Also Available In 240 VAC Input/Output.

Call or go online to order

UL File E86797  
Listed 41EA



Spoked Orifice  
Patent No. 10,323,664

# 1804 p/n 47651-A

Indoor Pump Control

Patent No. 5,162,624

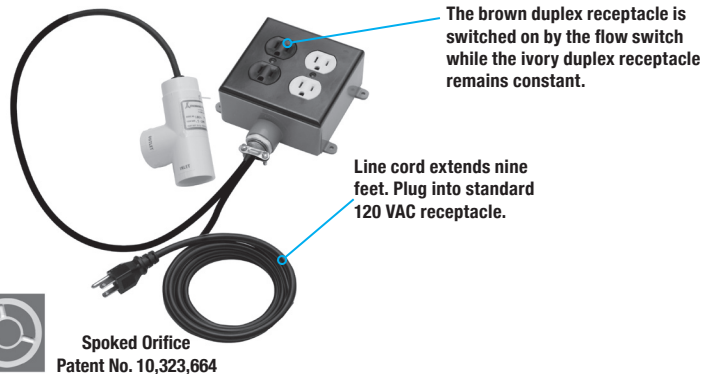

## 1804 Features\*

- 1" Slip Ports / Adapters Available On Page Six.
- Calibrated @ 0.5 GPM On Decreasing Flow.
- Flow Set Points Available To 6.0 GPM.
- Locking Wire For Easy Disassembly and Cleaning.
- True-Flow Switch Design Utilizes an SST Return Spring For Any Mounting Attitude.
- Input 120 VAC / Output 120 VAC 10A 1/2 HP.
- Also Available In 240 VAC Input/Output.

Call or go online to order

# 1804 W p/n 47650-A

Outdoor Pump Control

Patent No. 5,162,624

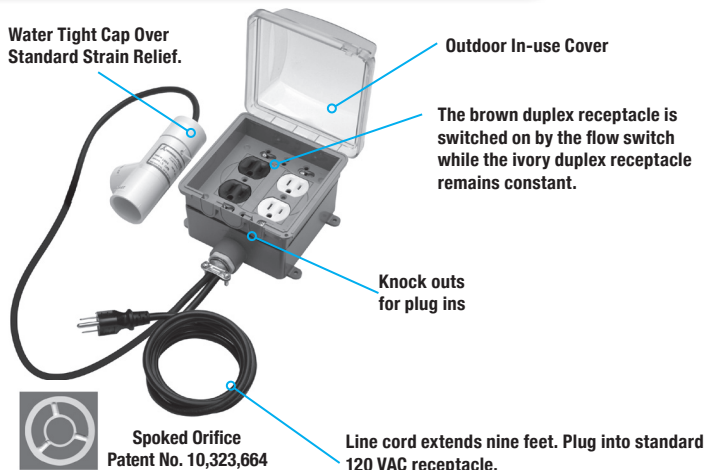

## 1804 W Features\*

- Has Water Tight Cap Over Standard Strain Relief.
- 1" Slip Ports / Adapters Available On Page Six.
- Flow Set Points Available To 6.0 GPM.
- Locking Wire For Easy Disassembly and Cleaning.
- Locking Cover To Protect Accidental Unplugging.
- Calibrated @ 0.5 GPM On Decreasing Flow.
- True-Flow Switch Design Utilizes an SST Return Spring For Any Mounting Attitude.
- Input 120 VAC / Output 120 VAC 10A 1/2 HP.
- Also Available In 240 VAC Input/Output.

Call or go online to order

\* Detailed specifications for all products and accessories can be found on pages five and six.

## 2601 p/n 46001-A

Indoor Pump Control

Patent No. 5,162,624

(NOTE: 2601 is the most used residential model)

UL File E86797  
Listed 41EA

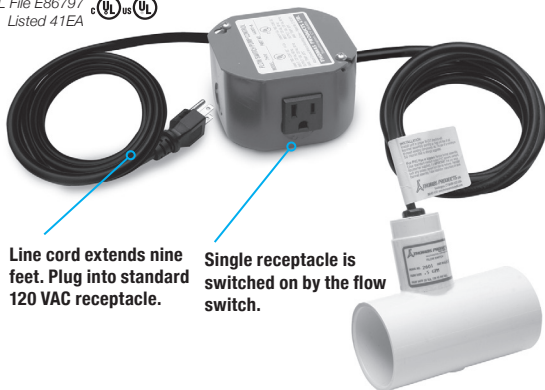

Line cord extends nine feet. Plug into standard 120 VAC receptacle.

Single receptacle is switched on by the flow switch.

## 2604 p/n 47451

Indoor Pump Control

Patent No. 5,162,624

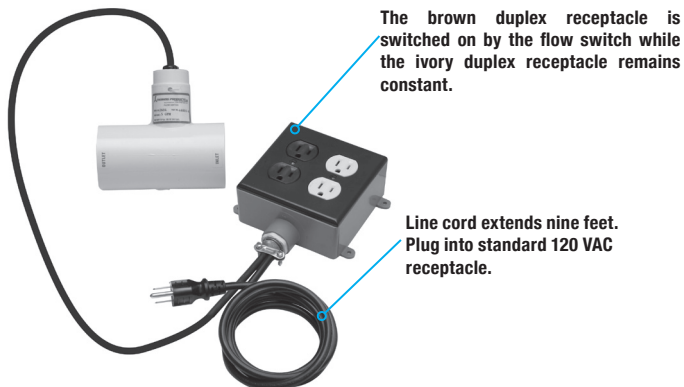

The brown duplex receptacle is switched on by the flow switch while the ivory duplex receptacle remains constant.

Line cord extends nine feet. Plug into standard 120 VAC receptacle.

## 2604 W p/n 47452

Indoor Pump Control

Patent No. 5,162,624

Water Tight Cap Over Standard Strain Relief.

Outdoor In-use Cover

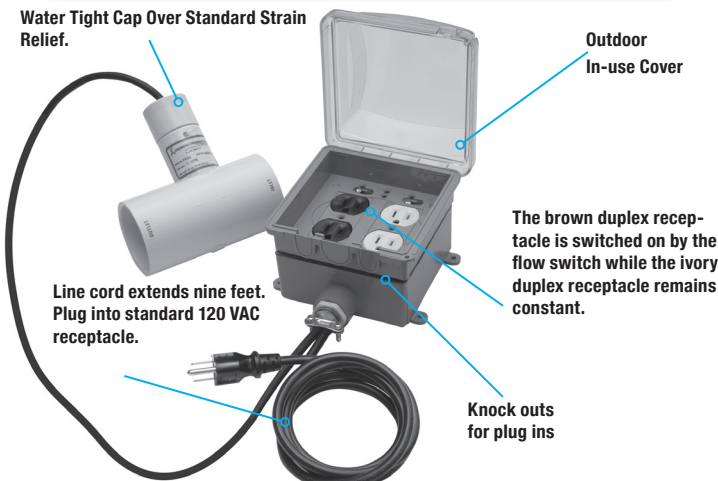

Line cord extends nine feet. Plug into standard 120 VAC receptacle.

The brown duplex receptacle is switched on by the flow switch while the ivory duplex receptacle remains constant.

Knock outs for plug ins

## 2601 Features\*

- 2" Slip Ports / Adapters Available On Page Six.
- Calibrated @ 0.5 GPM On Decreasing Flow.
- Flow Set Points Available To 6.0 GPM.
- Locking Wire For Easy Disassembly For Cleaning.
- True-Flow Switch Design Utilizes An SST Return Spring For Any Mounting Attitude.
- Patented Design SST Clapper Lower  $\Delta P$  And Opens To Pass High Flow Rates.
- Input 120 VAC / Output 120 VAC 10A 1/2 HP.
- Also Available In 240 VAC Input/Output.

Call or go online to order

UL File E86797  
Listed 41EA



## 2604 Features\*

- 2" Slip Ports / Adapters Available On Page Six.
- Calibrated @ 0.5 GPM On Decreasing Flow.
- Flow Set Points Available To 6.0 GPM.
- Locking Wire For Easy Disassembly For Cleaning.
- True-Flow Switch Design Utilizes An SST Return Spring For Any Mounting Attitude.
- Patented Design SST Clapper Lower  $\Delta P$  And Opens To Pass High Flow Rates.
- Input 120 VAC / Output 120 VAC 10A 1/2 HP.
- Also Available In 240 VAC Input/Output.

Call or go online to order

## 2604 W Features\*

- Has Water Tight Cap Over Standard Strain Relief.
- 2" Slip Ports / Adapters Available On Page Six.
- Flow Set Points Available To 6.0 GPM.
- Locking Wire For Easy Disassembly For Cleaning.
- Locking Cover To Protect Accidental Unplugging.
- Calibrated @ 0.5 GPM On Decreasing Flow.
- Patented Clapper Design Allows A Bypass Mode To Flow Much More Than Set Point.
- True-Flow Switch Design Utilizes An SST Return Spring For Any Mounting Attitude.
- Patented Design SST Clapper Lower  $\Delta P$  And Opens to Pass High Flow Rates.
- Input 120 VAC / Output 120 VAC 10A 1/2 HP.
- Also Available In 240 VAC Input/Output

Call or go online to order

\* Detailed specifications for all products and accessories can be found on pages five and six.



## 2651 p/n 47850-B

Indoor Pump Control

Patent Pending

(NOTE: 2651 is the most used residential model)

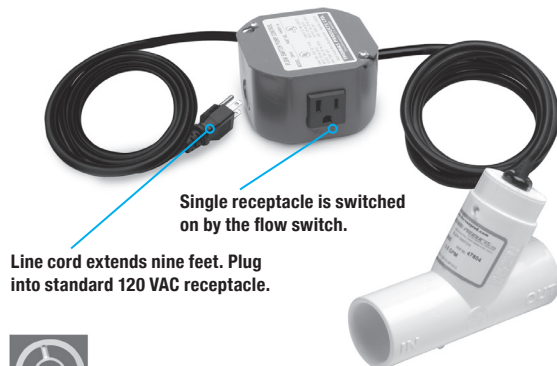

Spoked Orifice  
Patent No. 10,323,664

## 2654 p/n 47925

Indoor Pump Control

Patent Pending

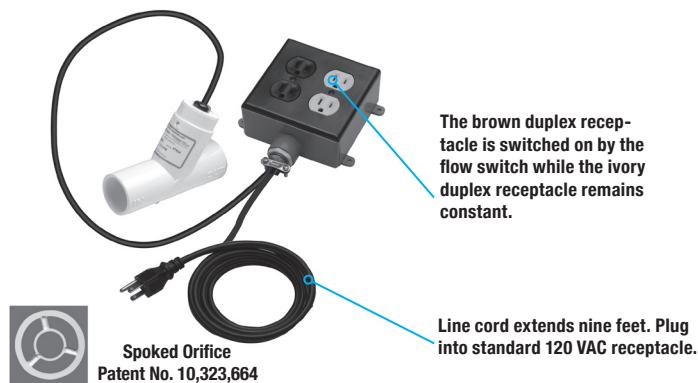

Spoked Orifice  
Patent No. 10,323,664

## 2654 W p/n 47900

Outdoor Pump Control

Patent Pending



Spoked Orifice  
Patent No. 10,323,664

## 2651 Features\*

- 1" Slip Ports / Adapters Available On Page Six.
- Calibrated @ 0.5 GPM On Decreasing Flow.
- Flow Set Points Available To 6.0 GPM.
- Locking Wire For Easy Disassembly For Cleaning.
- True-Flow Switch Design Utilizes An SST Return Spring For Any Mounting Attitude.
- Input 120 VAC / Output 120 VAC 10A 1/2 HP.
- Also Available In 240 VAC Input/Output.

Call or go online to order

UL File E86797  
Listed 41EA 

## 2654 Features\*

- 1" Slip Ports / Adapters Available On Page Six.
- Calibrated @ 0.5 GPM On Decreasing Flow.
- Flow Set Points Available To 6.0 GPM.
- Locking Wire For Easy Disassembly For Cleaning.
- True-Flow Switch Design Utilizes An SST Return Spring For Any Mounting Attitude.
- Input 120 VAC / Output 120 VAC 10A 1/2 HP.
- Also Available In 240 VAC Input/Output.

Call or go online to order

## 2654 W Features\*

- Has Water Tight Cap Over Standard Strain Relief.
- 1" Slip Ports / Adapters Available On Page Six.
- Flow Set Points Available To 6.0 GPM.
- Locking Wire For Easy Disassembly For Cleaning.
- Locking Cover To Protect Accidental Unplugging.
- Calibrated @ 0.5 GPM On Decreasing Flow.
- True-Flow Switch Design Utilizes An SST Return Spring For Any Mounting Attitude.
- Input 120 VAC / Output 120 VAC 10A 1/2 HP.
- Also Available In 240 VAC Input/Output.

Call or go online to order

\* Detailed specifications for all products and accessories can be found on pages five and six.

# 1800

p/n see chart on pg. 5

Flow Switch Only

Patent No. 5,162,624

Spoked Orifice  
Patent No. 10,323,664



Solid one piece removable bonnet assembly means safer use to 150 PSI.

True-flow switch design utilizes an SST return spring for any mounting attitude.

Anti-meniscus projections on shuttle prevents shuttle from drying in place after long machine shutdowns.



UL File E86797

## 1800 Features\*

- PVC Construction.
- Removable Bonnet Assembly.
- Return Spring For Any Mounting Attitude.
- 1" Slip Ports / Adapters Available On Page Six.
- Spoked Orifice For Laminar Flow.
- All Models Feature Clean In Place Technology.

# 2600

p/n see chart on pg. 5

Flow Switch Only

Patent No. 5,162,624

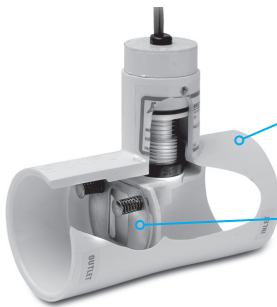

Plastics are molded in-house using only 100% virgin material. Runners are not reintroduced to the performance parts.

Patented design SST clapper lower  $\Delta P$  and helps pass particulates.



UL File E86797

## 2600 Features\*

This unit has the same low flow set point but has patented super high operational flow especially suited for chemical systems.

- Removable Bonnet Assembly.
- Replacement Parts Available.
- 2" Slip Ports / Adapters Available On Page Six.
- All Models Feature Clean In Place Technology.

# 2650

p/n see chart on pg. 5

Flow Switch Only

Patent Pending

Spoked Orifice  
Patent No. 10,323,664

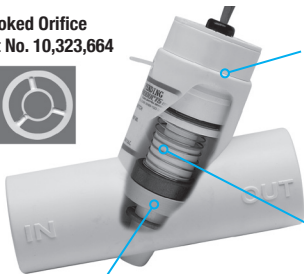

Solid one piece removable bonnet assembly means safer use to 150 PSI.

True-flow switch design utilizes an SST return spring for any mounting attitude.

Anti-meniscus projections on shuttle prevents shuttle from drying in place after long machine shutdowns.



UL File E86797

## 2650 Features\*

- PVC Construction.
- Removable Bonnet Assembly.
- Return Spring For Any Mounting Attitude.
- 1" Slip Ports / Adapters Available On Page Six.
- Spoked Orifice For Laminar Flow.
- All Models Feature Clean In Place Technology.

\* Detailed specifications for all products and accessories can be found on pages five and six.

# Flow Switch Specifications

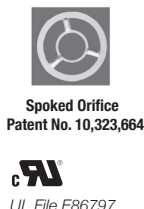
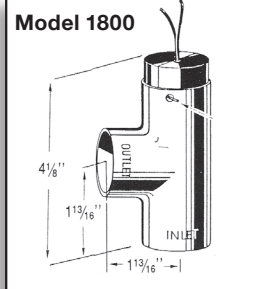

## Flow Setting 1800, 1801, 1804, 1804 W

Standard Flow Setting	P/N
0.5 GPM	42549-A
1.0 GPM	42545-A

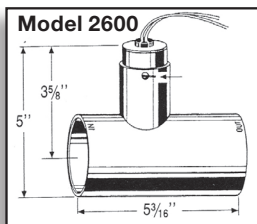
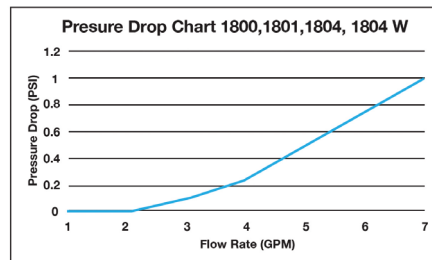

## Flow Setting 2600, 2601, 2604, 2604 W

STD. Flow Setting	0.5 GPM	1.0 GPM	2.0 GPM
P/N	42591	42952	42953

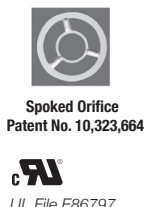
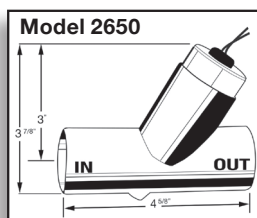
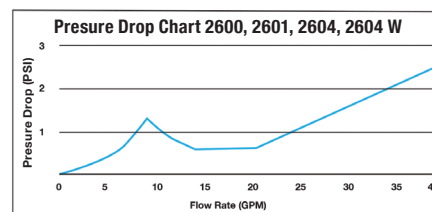

## Flow Setting 2650, 2651, 2654, 2654 W

Standard Flow Setting	P/N
0.5 GPM	47800
1.0 GPM	47801

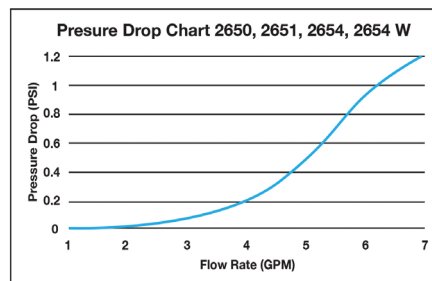

## Specifications 1800 & 2600, 2650 (flow switches only)

Construction	PVC Housing & Shuttle
Spring	316 SST
O-Ring	Viton "A"
Wire Leads	18 AWG, 24" Lg.
Oper. Temp	- 20° F / + 140° F
Max. Pres.	150 PSIG
Set Pt. Accur.	Accur. ± 20% Diff. 20% MAX
Reed Switch	20 Watt SPST

Electrical 1800, 2600, 2650  
Reed switch shown in NO FLOW condition.

RED

**SPST, NORMALLY OPEN AT NO FLOW**

Switch Ratings...  
Max Resistive Load

V.A.	Volts	AMPS DC	AMPS AC	AMPS AC MAX
20	0 - 50	.4	.4	1.0
	120	.15	.16	
	240	.06	.08	

Switch Rating 20 VA: 50 - 240 VAC Pilot Duty

## Unique Patented Bonnet Assembly Is Typical To Most Models

True positive displacement flow switch, utilizing an SST return spring.

Running lands help pass particulates.

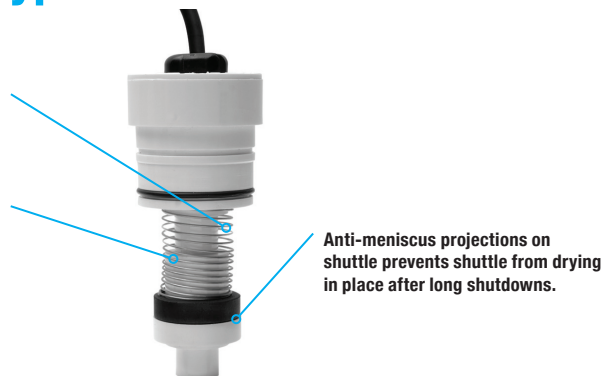

## Typical for above flow switches

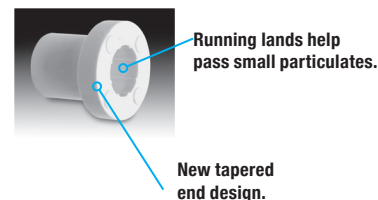

Newly Designed Shuttle  
With Running Lands!

Standard flow calibration is in water @ 70° F with lead wires up. Calibrated on decreasing flow. **Calibration:** Flow standards are calibrated to the national Bureau of Standards and Thomas Products LTD. recalibration schedule.





# Flow Switch Adapters

## Recommended Adapters 1800, 1801, 1804, 1804W

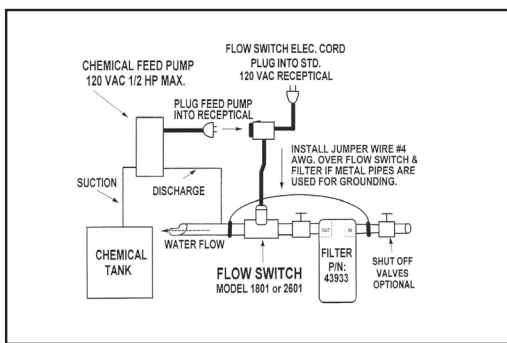
May be used with 1" slip ports or any combination shown		
P/N	Dimensional Data	
42751		3/4" Slip
42752		1/2" Slip
42753		3/4" NPT
42754		1/2" NPT

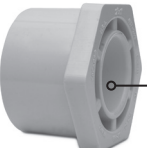

## Recommended Adapters 2600, 2601, 2604, 2604W

May be used with 2" slip ports or any combination shown		
P/N	"A"	Dimensional Data
42954	1 1/2"	
42955	1 1/4"	
42956	1"	
42957	3/4"	
42958	1/2"	
P/N	"B"	Dimensional Data
42959	1 1/2"	
42960	1 1/4"	
42961	1"	
42962	3/4"	
42963	1/2"	

## PREWIRED NO ELECTRICIAN NEEDED SIMPLY PLUG AND GO

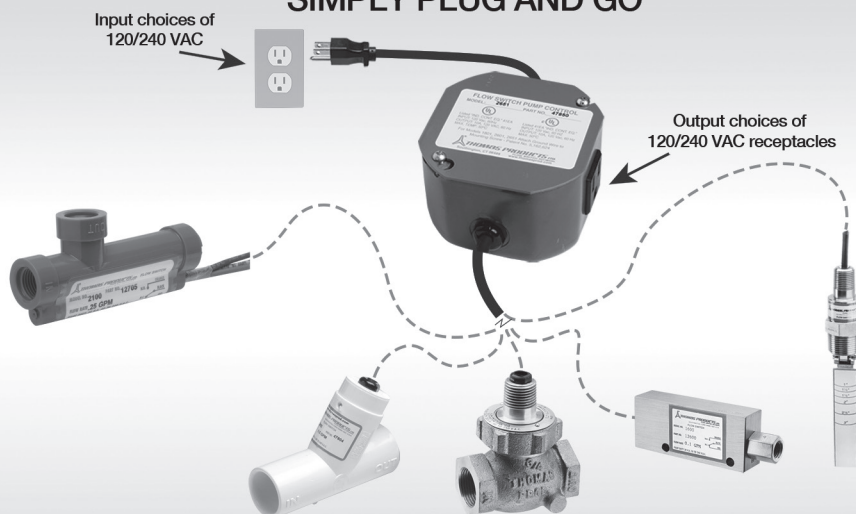

Any of our flow or level sensors can be factory ordered connected to any **TPL Controller™** operating your high-powered devices such as pumps, solenoid valves, compressors Etc.



# Quality Products and Simplicity of Installation

Thomas Products Limited has always delivered innovative problem-solving solutions for the water treatment industry, take, for example, our product line of water treatment pump controls, designed to treat severe water conditions. A residential water supply [ well water supply ] is not constant. Seasonal changes between wet and dry conditions can alter the water supply in a well. These dry and wet conditions create a problem for a homeowner who needs to treat water with the precise amount of chemicals to water ratio. When done correctly using our pump controls, a neutralized and safe quantity of well water can be delivered, making it neutral, pleasant, safe to consume and use for household tasks such as cooking, laundry, etc. In many cases, residential treated well water is far superior to city municipal water quality.

Please read the simple little paragraph on the front cover that summarizes the problem we solved for one of our biggest customers. They asked us to develop a solution to keep their customers safe. Too many injuries and accidents were happening, so we invented models that virtually eliminate this type of problem.

For an informative video on this and many more products, please see our YouTube channel.

## Want to install it yourself?

We'll be glad to help!

Full factory support for DIY

or have an experienced installer do it for you.

## Worldwide distribution and support!



Visit us online  
for tutorials & more  
[www.thomasprod.com](http://www.thomasprod.com)



987 West St. • Southington, CT 06489

860.621.9101 • Fax 860.621.1470

800.666.9101

[www.thomasprod.com](http://www.thomasprod.com)

[sales@thomasprod.com](mailto:sales@thomasprod.com)



## Authorized Distributor